

ARO

CONTROL HANDLE

66471 ASS'Y. (ADAPTER & GUN)

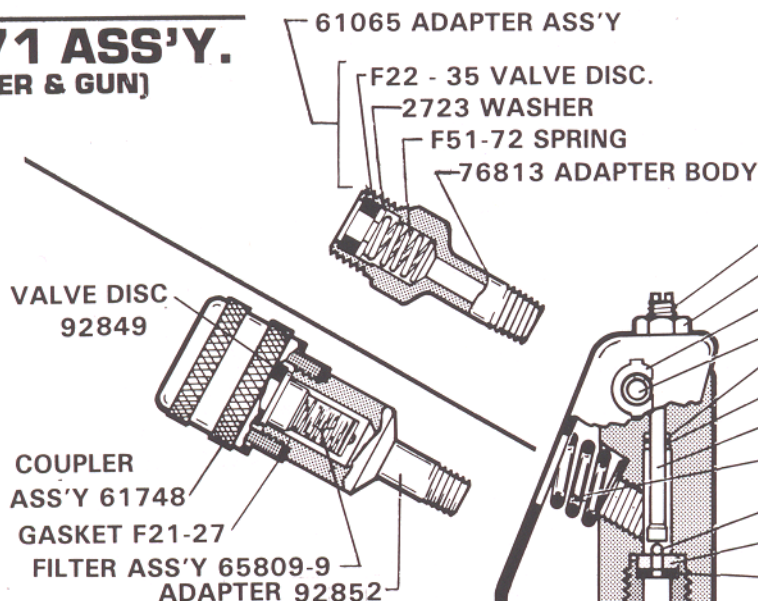

66472-1-B ASS'Y. (ADAPTER & GUN)

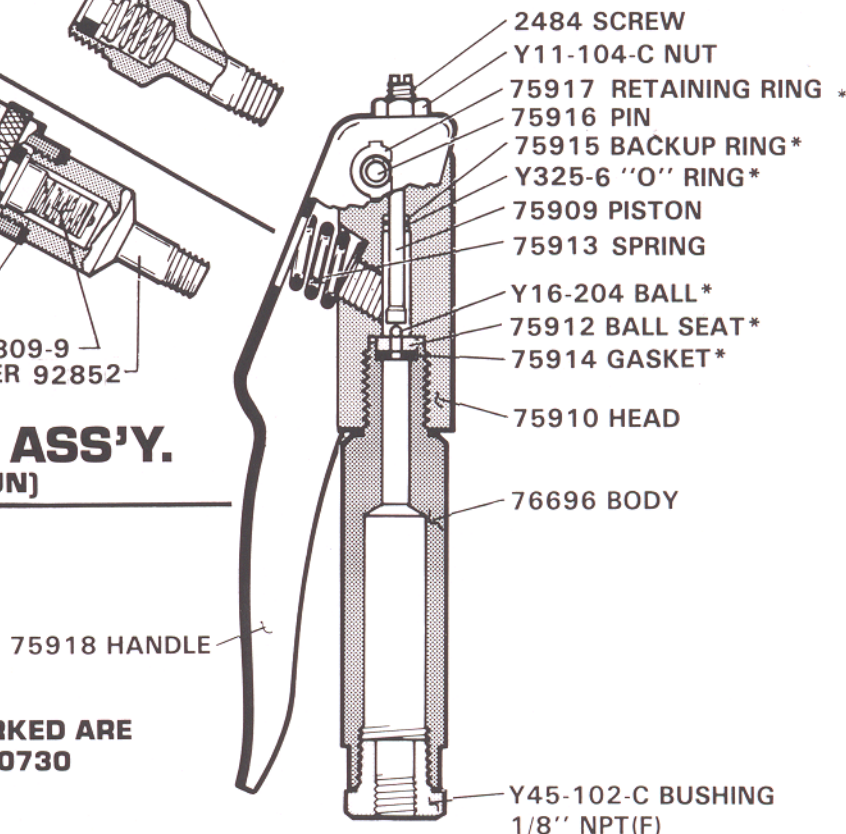

*PARTS SO MARKED ARE
INCLUDED IN 60730
SERVICE KIT

WARNING: HIGH PRESSURE DEVICE

IMPROPER USAGE OF EQUIPMENT COULD RESULT IN SERIOUS INJURY. THE POSSIBILITY OF INJECTION INTO THE FLESH IS A POTENTIAL HAZARD. NEVER ALLOW ANY PART OF THE HUMAN BODY TO COME IN FRONT OF OR IN DIRECT CONTACT WITH THE MATERIAL OUTLET.

AN INJECTION INJURY CAN BE SERIOUS! IF INJECTION SHOULD OCCUR, CONTACT A QUALIFIED PHYSICIAN FOR IMMEDIATE TREATMENT AND CONTACT THE PITTSBURGH POISON CENTER (1-412-681-6669) FOR PRESCRIBED TREATMENT OF SUCH INJURIES.

DO NOT EXCEED MAXIMUM WORKING PRESSURE OF 1800 P.S.I. (124 BAR)

NOTICE:

READ THIS MANUAL CAREFULLY BEFORE OPERATING,
INSTALLING OR SERVICING THIS EQUIPMENT.

THE ARO CORPORATION

PRINTED IN USA
© 1984 THE ARO CORPORATION

ONE ARO CENTER, BRYAN, OHIO 43506
PHONE - 419-636-4242

ARO

SERVICE INSTRUCTIONS

1. To adjust slack in handle, loosen Y11-104-C nut, then adjust 2484 screw. After adjusting to desired position, tighten Y11-104-C nut.
2. Should material leak from top of unit, replace Y325-6 "O" Ring and check 75915 back-up ring. To remove "O" Ring:
 - a. Relieve line pressure.
 - b. Remove 75910 head from 76696 body; **be sure not to lose Y16-204 Ball.**
 - c. Remove 75909 piston.
 - d. Remove and replace Y325-6 "O" Ring.
 - e. Reassemble, making sure Y325-6 "O" Ring and 75915 back-up ring are seated firmly in counter-bore.
3. Should material leak from tip even though the handle is not depressed, make sure handle is not depressed, make sure handle is releasing completely. This usually can be done by making sure the

75913 spring tension is great enough to overcome the material pressure forcing the ball off the seat. Spring tension can be increased by loosening the Y11-104-C nut, and turning 2484 screw one or more turns clockwise.

If screw adjustment does not stop leak:

- a. Relieve line pressure.
 - b. Remove 75910 head from 76696 body.
 - c. Clean or replace Y16-204 ball and 75912 ball seat.
 - d. Reassemble.
4. If the flow of material from the control handle has decreased, check the following:
 - a. The 61033 screen in spray gun extension ass'y.
 - b. Check and clean the 65809-9 filter ass'y in the 92852 adapter. (66472-1-B Only)

The above may be cleaned by removing and blowing air in the opposite direction of the material flow. The screen should then be cleaned in a suitable solvent.